

This Quick Start Guide is provided so that you can properly set up your new TV.

## 1 PACKAGE CONTENT

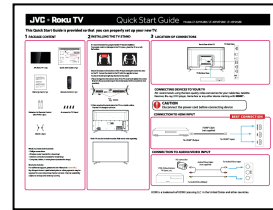

JVC Roku TV x 1pc



Quick Start Guide x 1pc



Warranty Card x 1pc



Remote Control x 1pc



Batteries for Remote Control (Size AAA) x 2pcs



4x screws for TV Stand



Stands x 2pcs

### What you need (not included)

- Phillips screw driver
- Wireless router (needed for streaming)
- Internet connection (needed for streaming)
- Computer, tablet, or smart phone (needed for setup)

For additional support, please refer to User Manual and JVC Customer Support at

<http://go.roku.com/tvmanual>

<https://jvcsmart.com/pages/contact>

Key things to know: A paid subscription or other payments may be required for some streaming channel content. Channel availability subject to change and varies by country.

## 2 INSTALLING THE TV STAND

It is recommended two people handle TV stand installation. To prevent scratch or damage to the TV screen, place the TV on a soft, flat surface.

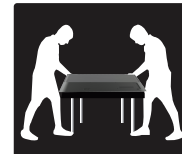

Attach the stands to the bottom of the TV by inserting the stand into slots on the TV. Secure the stands to the TV with the supplied screws.

To attach the left and right leg that forms the stand:

1. Place the legs into the bottom slots of the TV, insert and tighten the screws (found in the accessories bag) in the circled areas with the screwdriver (not provided).

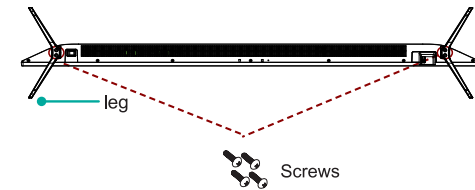

2. After securing the stand, place the TV on a stable surface. The TV is ready for use now.

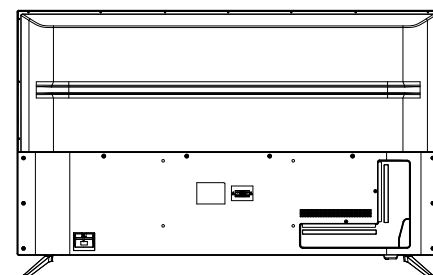

Note: TV can also be wall mounted. Wall mount sold separately.

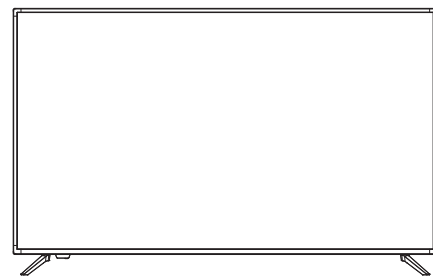

## 3 LOCATION OF CONNECTORS

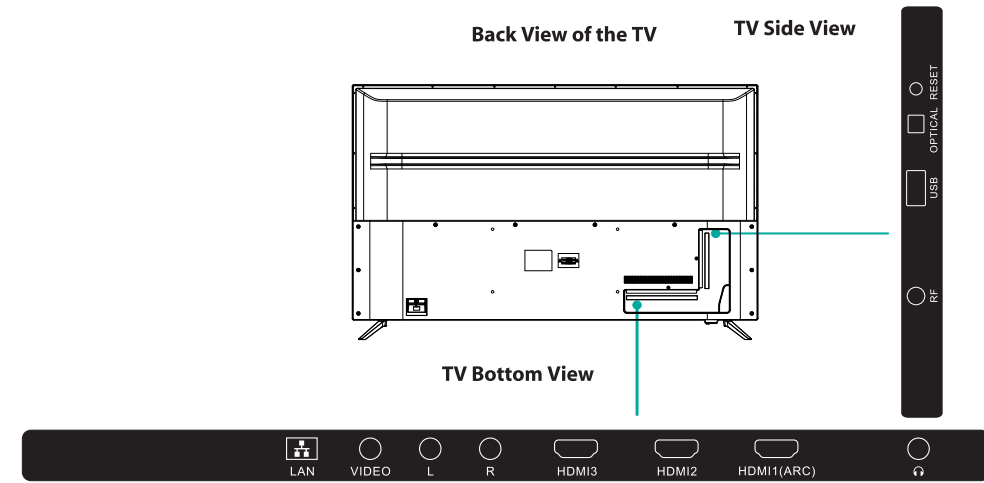

## 4 CONNECTING DEVICES TO YOUR TV

JVC recommends using the best-quality video connection for your Cable Box, Satellite Receiver, Blu-ray, DVD player, Game box or any other device starting with **HDMI®**.



### CAUTION

Disconnect the power cord before connecting device

### CONNECTION TO HDMI INPUT

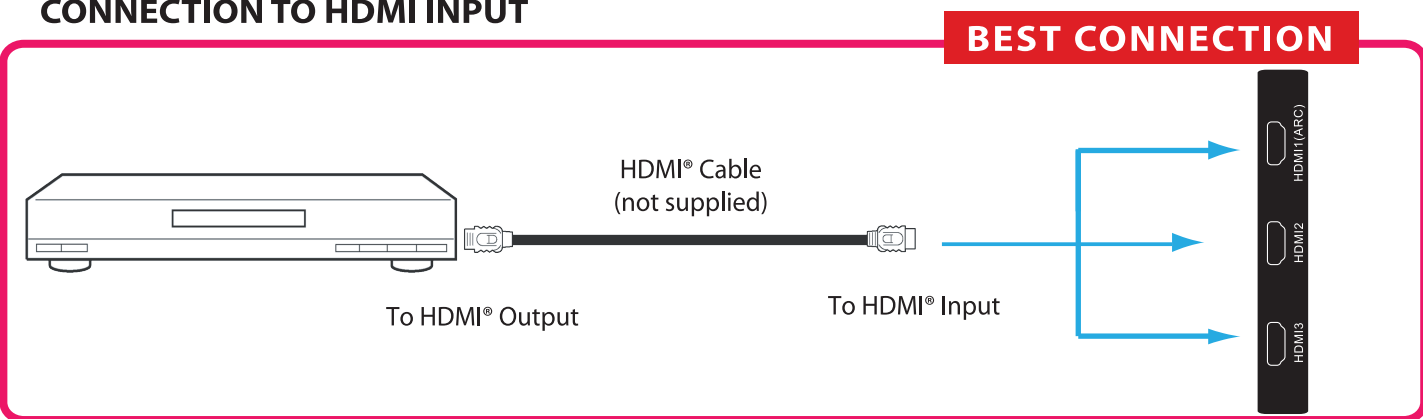

### CONNECTION TO AUDIO/VIDEO INPUT

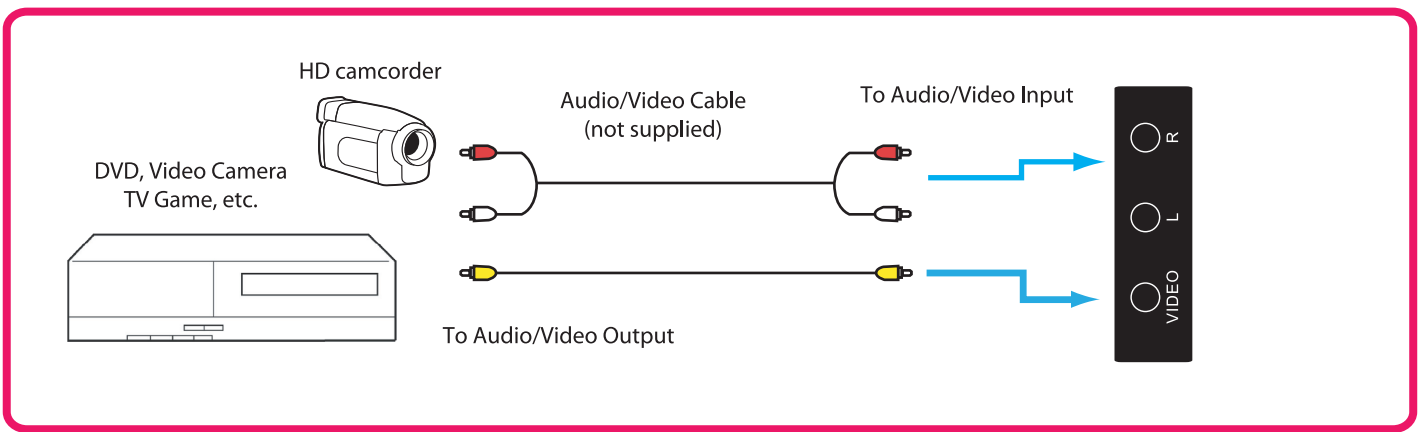

HDMI is a trademark of HDMI Licensing LLC in the United States and other countries.

## 5 SETTING UP YOUR TV

### 1. Place batteries in remote

Power your TV remote by inserting the included batteries carefully matching (+) and (-) indicated inside the battery compartment.

Tip: Always replace dead batteries with two brand-new batteries from the same manufacturer. Never use damaged batteries.

If your remote gets warm/hot during use, discontinue use and contact customer support immediately at <https://jvcsmart.com/pages/contact>

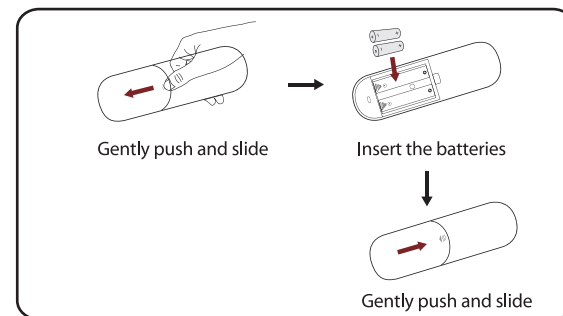

### 2. Plug in and turn on TV

Connect your power cord to the TV, then plug it into the wall outlet.

Press the power button on your TV remote control.

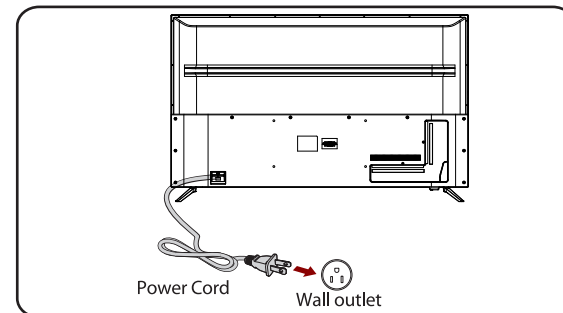

### 3. Follow the on-screen instructions

Once your Roku TV powers on, follow the on-screen instructions. Your Roku TV will walk you through initial setup and help connect to your preferred wireless network.

Your TV will automatically detect wireless networks in your area. Have your network name and password handy and follow the easy on-screen instructions. Once connected your TV will automatically update with the latest software.

This can take a few minutes to update.

If you aren't ready to connect your TV to a wireless network, you can still use it as a regular TV.



### 4. Activate your smart TV

You need a Roku account to activate your Roku TV and access entertainment across thousands of streaming channels. From your smartphone, tablet or computer, go to [www.roku.com/link](http://www.roku.com/link) and enter the unique link code that is displayed on your TV screen. Roku accounts are free and while a valid credit card number is not required to create a Roku account, saving your credit card information makes renting and purchasing entertainment from the Roku Channel Store fast and convenient.

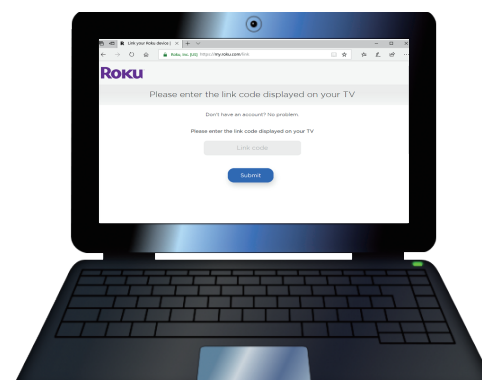

**NOTE: Roku does not charge for activation support – beware of scams.**

## 6 CONNECT AN ANTENNA (OPTIONAL)

Check to ensure that you have selected the right cables for the ports and that they are connected securely. Loose connections can affect the quality of the picture image and color. (Cables and External Equipment not included.)

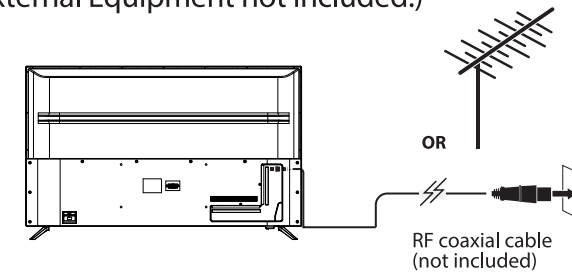

Note:  
Aerial connections : F connector.  
Input impedance : 75Ω unbalanced.

With the tuner built-in you can connect your TV to an antenna and enjoy over-the-air entertainment.

1. When the setup wizard is complete select the Antenna TV icon  from the home screen.

2. Follow the on-screen instructions.

3. Whenever you want to watch antenna TV, select the Antenna icon.

## 7 REMOTE CONTROL

The Roku TV remote should feel right at home in your hand. We designed it to be incredibly intuitive for watching TV and navigating on-screen menus.

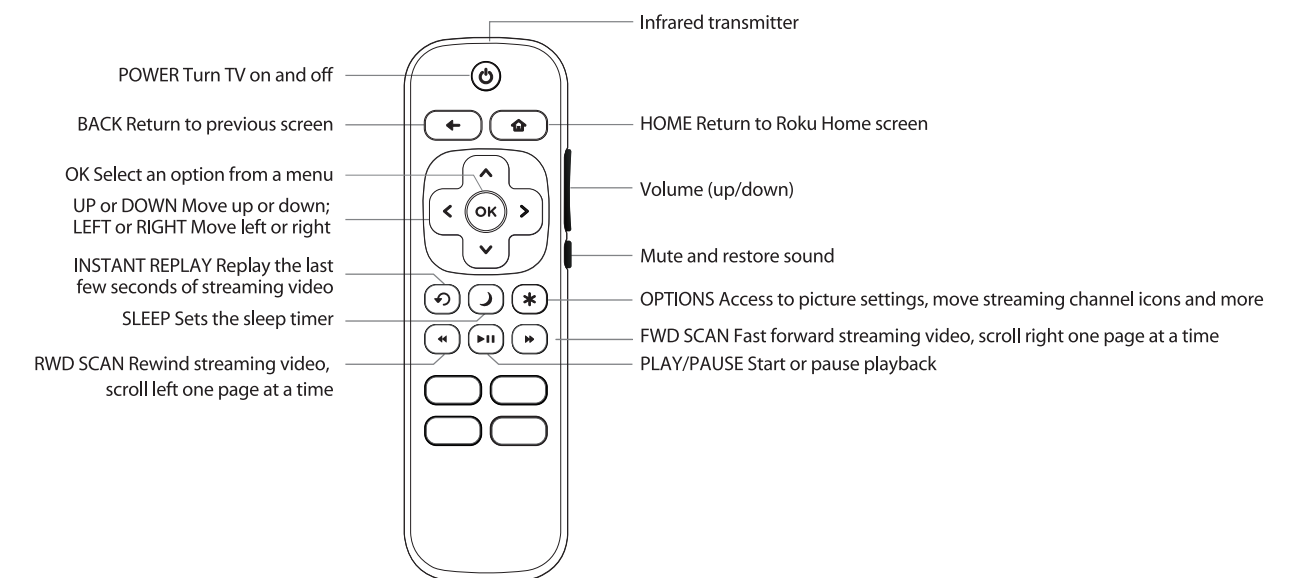

Tip: The  gives you easy access to picture settings, display options and more. Try it on every screen.

Tip: If you prefer to use your cable set-top box or satellite receiver remote as a Universal Remote, please refer to the manual that your cable or satellite service provided. It includes instructions on how to program their remote to your television. You can find codes that work with your JVC Roku TV and most common cable and satellite provider's universal remote controls at [www.roku.com/universalremote](http://www.roku.com/universalremote)."